

INSTALLATION INSTRUCTIONS

Attention Plumber:

you do NOT need to check this base in if water resistant plaster. just push against stud and follow instructions

WATER RESISTANT PLASTER BOARD

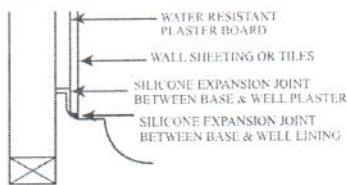

Attention Plumber:

you need to checkout the studs 3mm if using cement sheet / Villa Board or Blue board.

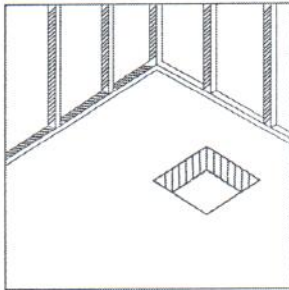
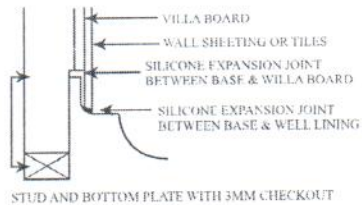

- *Floor Boards & Sheet Flooring 200mm x 200mm cut out
- *Concrete cut out 300mm x 300mm

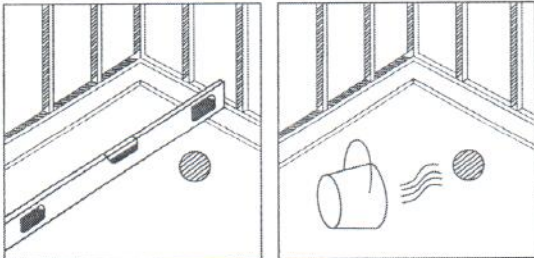

- *Check that the Shower Base sits level.
- *Test the water flow.

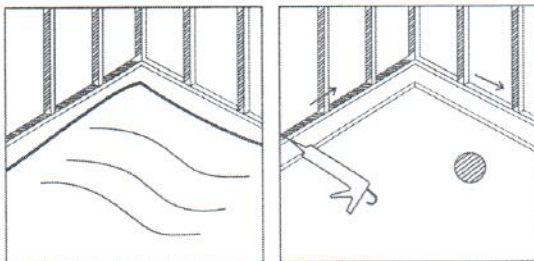

- *Cover and protect the Shower Base until shower screen & tiles are installed once the base is installed we will not be responsible for any scratches or chips or any damage, if the base is damaged we need to be notified and we will send a replacement.
- *Silicone the bottom edge of the Shower Wall to the base before the screen is fitted.

Water resistant plaster board installation shower base has a tile flange. Place base against framework, install water resistant plaster board directly on top of tile flange and seal joint with flexible silicone sealant.

Villa board installation. When using villa board the shower base will need to be checked into framework a minimum of 3mm Install villa board directly on top of tile flange and seal joint with flexible sealant.

1. Floor boards or sheet flooring must cover the entire underside of the base. Cut hole through floor no greater than 200mm x 200mm (concrete should be 300mm x 300mm).

2. Your shower base may be installed on silicone over entire base area. Lay base on floor and check for level both sides and front&rear. This will allow base to drain effectively as it has inbuilt fall to waste outlet.

Note: If your floor is not level use a cement based tile adhesive spread on floor with a 12mm notched trowel to ensure base is fully supported.

3. Finally it is imperative to test for water run off to the waste outlet prior to lining shower walls. This will ensure base is draining correctly. Failure to do so will breach the warranty.

4. It is recommended that you cover and protect the base until first use.

5. Silicone the bottom edges of the shower wall to the base before the screen is fitted.

Cleaning

The surface of this base will resist surface build-up. However, to preserve its high lustre it may be cleaned with a soft cloth using warm soapy water or household detergent.

Avoid All Forms Of Abrasive

If accidental abrasions occur the surface brilliance can be restored by polishing with silicone-based polish.

Warning

Warranty will be voided if temperature from tap exceeds 55°C and above instructions are not adhered to exactly.

Warranty is replacement only against straight line cracks, we will NOT pay for labour.

Bella Vista Bathware
 Fax:03-94459362
 Email:sale@bella-vista.net.au