

# Installation Instruction

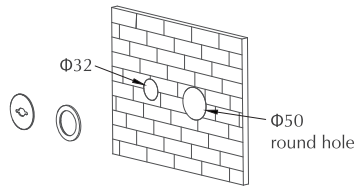

Note:

1. Hole size required for spout 32mm
2. Hole size required for mixer 50mm

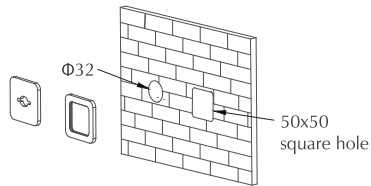

Note: (It fits Tiago & Beki range)

1. Hole size required for spout 32mm
2. Hole size required for mixer 50x50mm

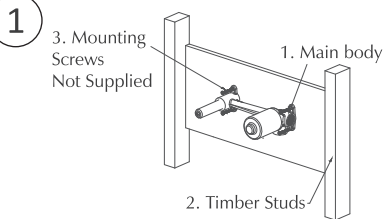

1. Place item ( Main Body) onto the timber studs or concrete wall e.t.c. screw into the frame.

( note: make sure mixer is level. )

1.1. Please don't remove protective cover until tiling is finished / Fit off.

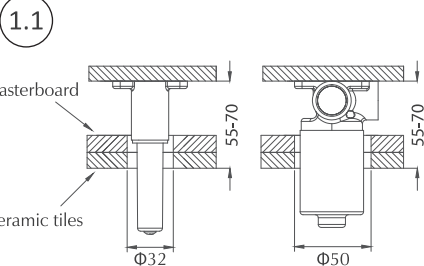

Installation tolerance: Depth 55-70mm from noggin to outer edge of ceramic tiles.

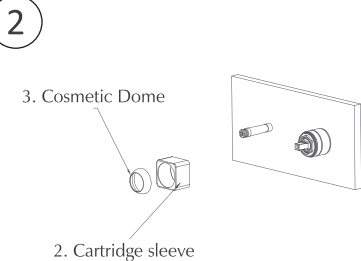

2. Install cartridge sleeve and cosmetic dome on the main body.

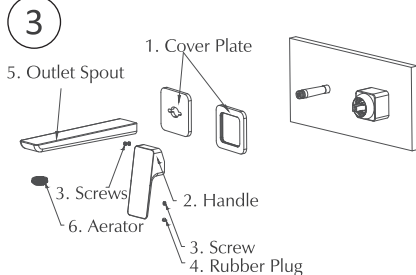

3. Install cover plate, Handle and outlet spout on the main body.

3.1. Install cover plate

3.2. Install handle and tighten the screw

3.3. Install outlet spout and tighten the screw